

PLAN FOR YOGESHWARI JANHITAY SEVAYATAN SANSTHAN AT VILLAGE AMLIPADA, TEH. SAJJANGARH, DISTT. BANSWARA (Raj.)

· KHASARA No. 2362/2361/1234, 2361/1234, 1234, 2367/1234
(NEW KH.NO.3162/3161,3168/1234,3161/1234 & 1234)

TOTAL AREA = 8600 Sqm. Or 0.8600 Hac.



SR	REMARK	SIZE	Sq Ft.	Sq.m.	Floor
21	CLASS ROOM	30'X20'	600	55.75	Ground Floor
22	CLASS ROOM	30'X20'	600	55.75	Ground Floor
24	SCIENCE LAB	30'X20'	600	55.75	Ground Floor
25	SCIENCE LAB	30'X20'	600	55.75	Ground Floor
42	CLASS ROOM	24'X20'	480	46	1st Floor
43	CLASS ROOM	24'X20'	480	46	1st Floor
44	CLASS ROOM	30'X20'	600	55.75	1st Floor
45	CLASS ROOM	30'X20'	600	55.75	1st Floor
50	2nd floor 1st Hall	55'X95'	5225	485.8	2nd Floor
	HE TOILET	12'X20'	240	22.3	Ground Floor
	SHE TOILET	12'X20'	240	22.3	Ground Floor
	PLAY GROUND	100'X100'	10000	929.3	Ground Floor
			20295	1886	

TOTAL LAND AREA = 92536 Sq. ft. (8600.00 Sqm)
GROUND FLOOR BUILTUP AREA = 18816 Sq. ft. (1748.70 Sqm)
FIRST FLOOR BUILTUP AREA = 18816 Sq. ft. (1748.70 Sqm)
SECOND FLOOR BUILTUP AREA = 14035 Sq. ft. (1304.36 Sqm)
TOTAL BUILTUP AREA = 51667 Sq.ft. (4801.76 Sqm.)



PLAN OF SHREE YOGESHWAR COLLEGE



SR	REMARK	SIZE	Sq Ft.	Sq.m.	Floor
3	CLASS ROOM	18'X20'	360	33.45	Ground Floor
8	CLASS ROOM	18'X20'	360	33.45	Ground Floor
11	CLASS ROOM	30'X20'	600	55.75	1st Floor
12	CLASS ROOM	30'X20'	600	55.75	1st Floor
13	CLASS ROOM	30'X20'	600	55.75	1st Floor
14	CLASS ROOM	30'X20'	600	55.75	1st Floor
15	CLASS ROOM	18'X20'	360	33.45	1st Floor
16	CLASS ROOM	18'X20'	360	33.45	1st Floor
32	CANTEEN	12'X20'	240	22.3	Ground Floor
33	MULTIPURPOSE HALL 2	30'X50'	1500	139.35	Ground Floor
34	SPORTS & GAMES	12'X20'	240	22.3	1st Floor
35	READING ROOM	20'X20'	400	37.16	1st Floor
36	CULTURAL ROOM	12'X20'	240	22.3	1st Floor
41	GUARD ROOM	10'X10'	100	9.29	Ground Floor
46	CLASS ROOM	30'X20'	600	55.75	1st Floor
47	CLASS ROOM	30'X20'	600	55.75	1st Floor
48	CLASS ROOM	30'X20'	600	55.75	1st Floor
49	PRINCIPAL RESIDENCE	50'X40'	2000	185.8	2nd Floor
51	2nd floor 2nd Hall	55'X95'	5225	485.8	2nd Floor
	HE TOILET	12'X20'	240	22.3	Ground Floor
	SHE TOILET	12'X20'	240	22.3	Ground Floor
			16065	1492.76	

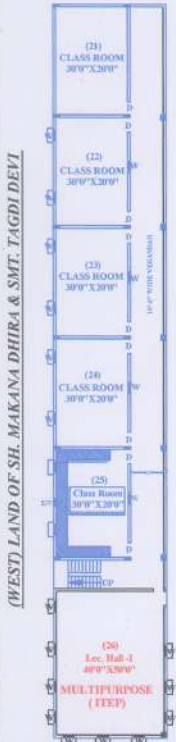

PLAN FOR (B.ED.) PROGRAMME

(NORTH) AGLI. LAND BHEEMA TAKHT

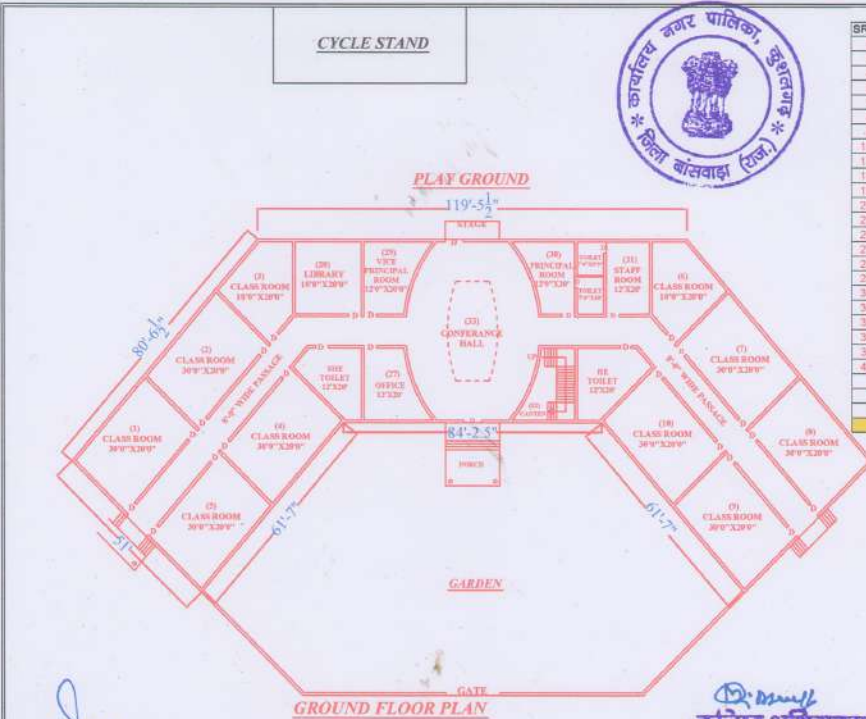

SR	REMARK	SIZE	Sq Ft.	Sq.m.	Floor
1	CLASS ROOM	30'X20'	600	55.75	Ground Floor
2	CLASS ROOM	30'X20'	600	55.75	Ground Floor
4	CLASS ROOM	30'X20'	600	55.75	Ground Floor
5	CLASS ROOM	30'X20'	600	55.75	Ground Floor
7	CLASS ROOM	30'X20'	600	55.75	Ground Floor
8	CLASS ROOM	30'X20'	600	55.75	Ground Floor
9	CLASS ROOM	30'X20'	600	55.75	Ground Floor
10	CLASS ROOM	30'X20'	600	55.75	Ground Floor
11	CLASS ROOM	30'X20'	600	55.75	1st Floor
18	CLASS ROOM	30'X20'	600	55.75	1st Floor
19	CLASS ROOM	30'X20'	600	55.75	1st Floor
20	CLASS ROOM	30'X20'	600	55.75	1st Floor
23	CLASS ROOM	30'X20'	600	55.75	Ground Floor
26	MULTIPURPOSE HALL 1	40'X50'	2000	185.8	Ground Floor
27	OFFICE	12'X20'	240	22.3	Ground Floor
28	LIBRARY	18'X20'	360	33.45	Ground Floor
29	VICE PRINCIPAL	12'X20'	240	22.3	Ground Floor
30	PRINCIPAL	12'X20'	240	22.3	Ground Floor
31	STAFF ROOM	12'X20'	240	22.3	Ground Floor
32	GEOGRAPHY LAB	18'X20'	360	33.45	1st Floor
38	PSYCHO LAB	12'X20'	240	22.3	1st Floor
39	COMMON ROOM	12'X20'	240	22.3	1st Floor
40	STORE ROOM	15'X15'	225	20.9	1st Floor
	HE TOILET	12'X20'	240	22.3	Ground Floor
	SHE TOILET	12'X20'	240	22.3	Ground Floor
	PLAY GROUND	100'X100'	10000	929.3	Ground Floor
			22665	2106.05	

सहायक अभियन्ता
नगर परिषद् बांसवाड़ा

कमलेश अभियन्ता
नगर पालिका कुशलगढ़
जिला बांसवाड़ा (राज.)

अधिसापी अधिकारी
नगर पालिका कुशलगढ़
जिला बांसवाड़ा (राज.)

PLAN FOR (ITEP) PROGRAMME

(SOUTH) TANDA MANGLA TO AMLIPADA ROAD

SITE PLAN FOR PROPOSED (TTEP) RUN BY YOGESHWARI JANHITAY SEVAYATAN
SANSTHAN AT VILLAGE AMLIPADA, TEH. SAJJANGARH, DISTT. BANSWARA (Raj.)

KHASARA No. 2362/2361/1234, 2361/1234, 1234, 2367/1234
(NEW KH.NO.3162/3161,3168/1234,3161/1234 & 1234)
TOTAL AREA = 8600 Sqm. Or 0.8600 Hac.



(NORTH) AGRI. LAND BHEEMA TAKHAT

(WEST) LAND OF SH. MAKANA
DHIRA & SMT. TAGDI DEVI

SITE PLAN

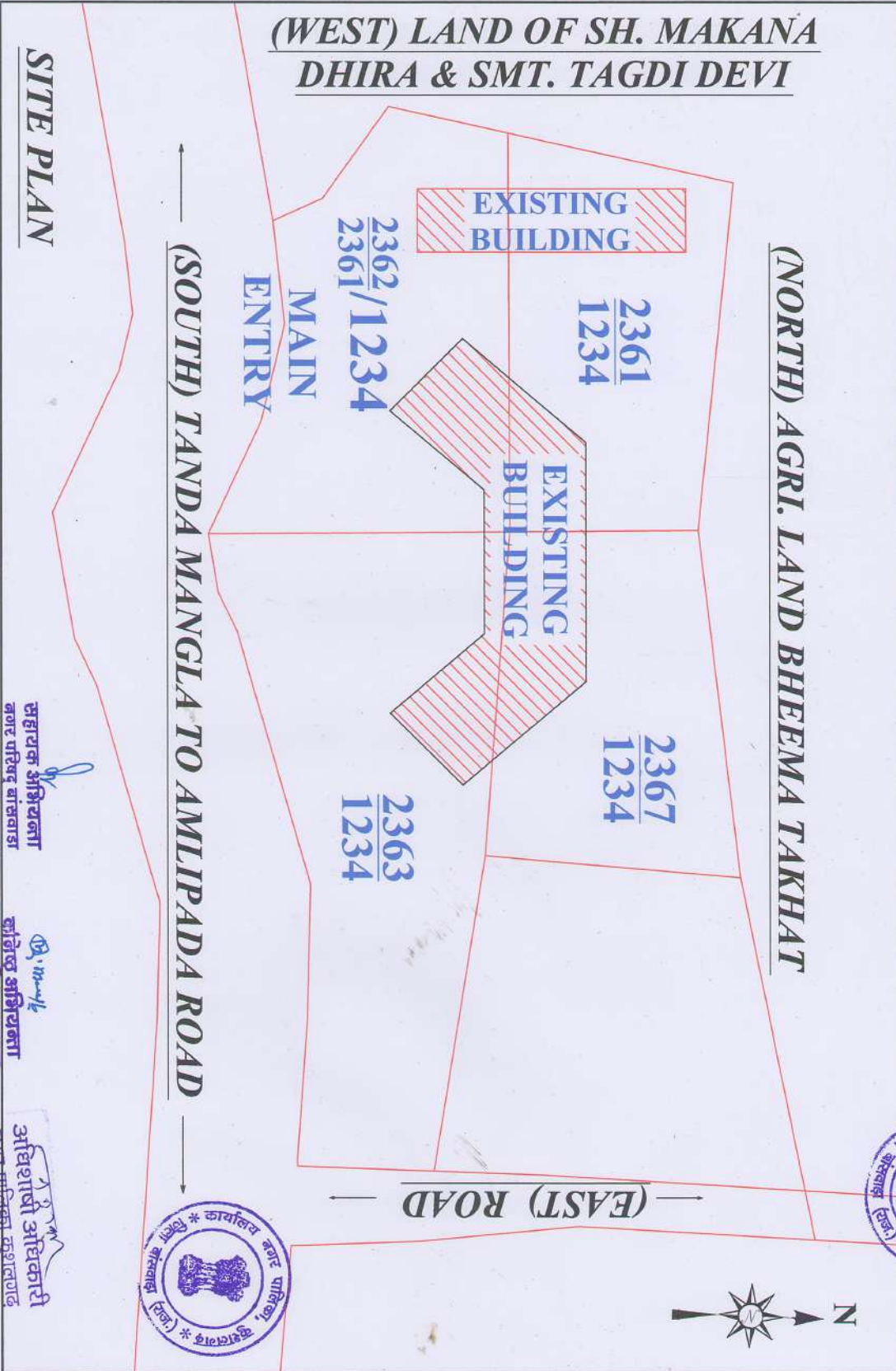

सहायक अभियन्ता
नगर परिषद बांसवाड़ा

कोटिन्द्र अभियन्ता
नगर परिषद बांसवाड़ा
जिला बांसवाड़ा (राज.)

अधिसूची अभियन्ता
नगर पंचायिका कुशालगढ़
जिला बांसवाड़ा (राज.)